



INSTRUCTIONS:

Dreambaby®

Converta® Play-Pen Gate

Conforms to EN 12227:2010

F2020 F2030 F2031

Item numbers may also end in BB.

IMPORTANT! READ AND FOLLOW THESE INSTRUCTIONS CAREFULLY AND KEEP FOR FUTURE REFERENCE

If you sell or give away this product, make sure you give this instruction to the new owner.

WARNING

- Suitable for children up to 24 months.
- Ensure that the Play-Pen is fully assembled and all the locking mechanisms engaged before placing your child in this Play-Pen.
- Do not place the Play-Pen close to an open fire or other heat source.
If using as a Fireplace Barrier, ensure it is installed at least 60cm/23.5in from fire source.
- Do not use Play-Pen at top of stairs.
- This Play-Pen is not intended for sleep use.
- This product does not replace adult supervision.
Never leave a child unattended.
- Never use with a child able to climb over or dislodge/open the gate/enclosure.
- Do not leave anything in the Play-Pen which may provide a foothold for climbing.
- The safety barrier is for domestic use only.
- The gate panel has a manual close system.
- The safety barrier must not be fitted across windows.
- Do not use if any components are missing or damaged.
- The Barrier can be used to create a landing area at the top or base of stairs.
Never use at top of stairs directly across top step.
- This product is intended for indoor use and is not to be exposed to outdoor elements.
- The surfaces that the safety gate is to be affixed to must be suitable for the purpose and must be structurally sound.

COMPONENTS

- A** Gate Panel
- B** Barrier Panel
- C** Release Button
- D** Tension Knobs
- E** Wall Mount (x2)
- F** Screws (x8)
- G** Masonry Plugs (x8)
- H** One-Way Stopper
- I** Gate Release Switch
- J** Connector
 - J1** -Top of Connector
 - J2** -Base of Connector
- K** 2-Way Switch
- L** Small Spacer
- M** Large Spacer
- N** Spacer Screws

Before you start

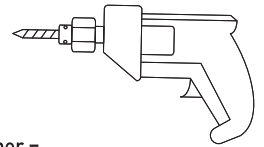
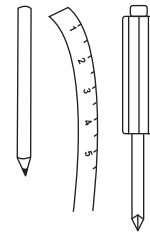

Timber =
2mm (5/64in) drill bit
Brick/masonry =
5.5mm (7/32in) drill bit

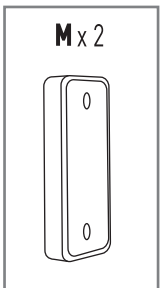
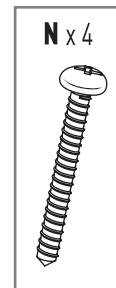
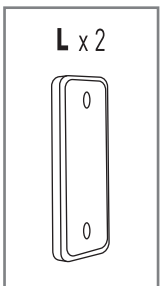
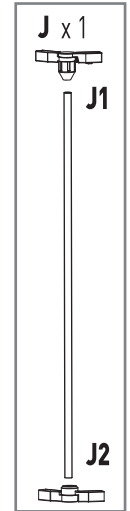
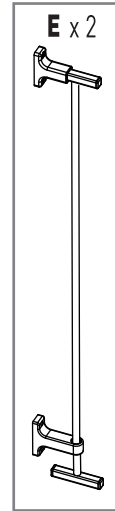
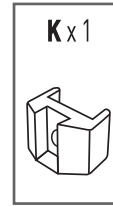
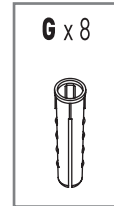
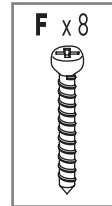
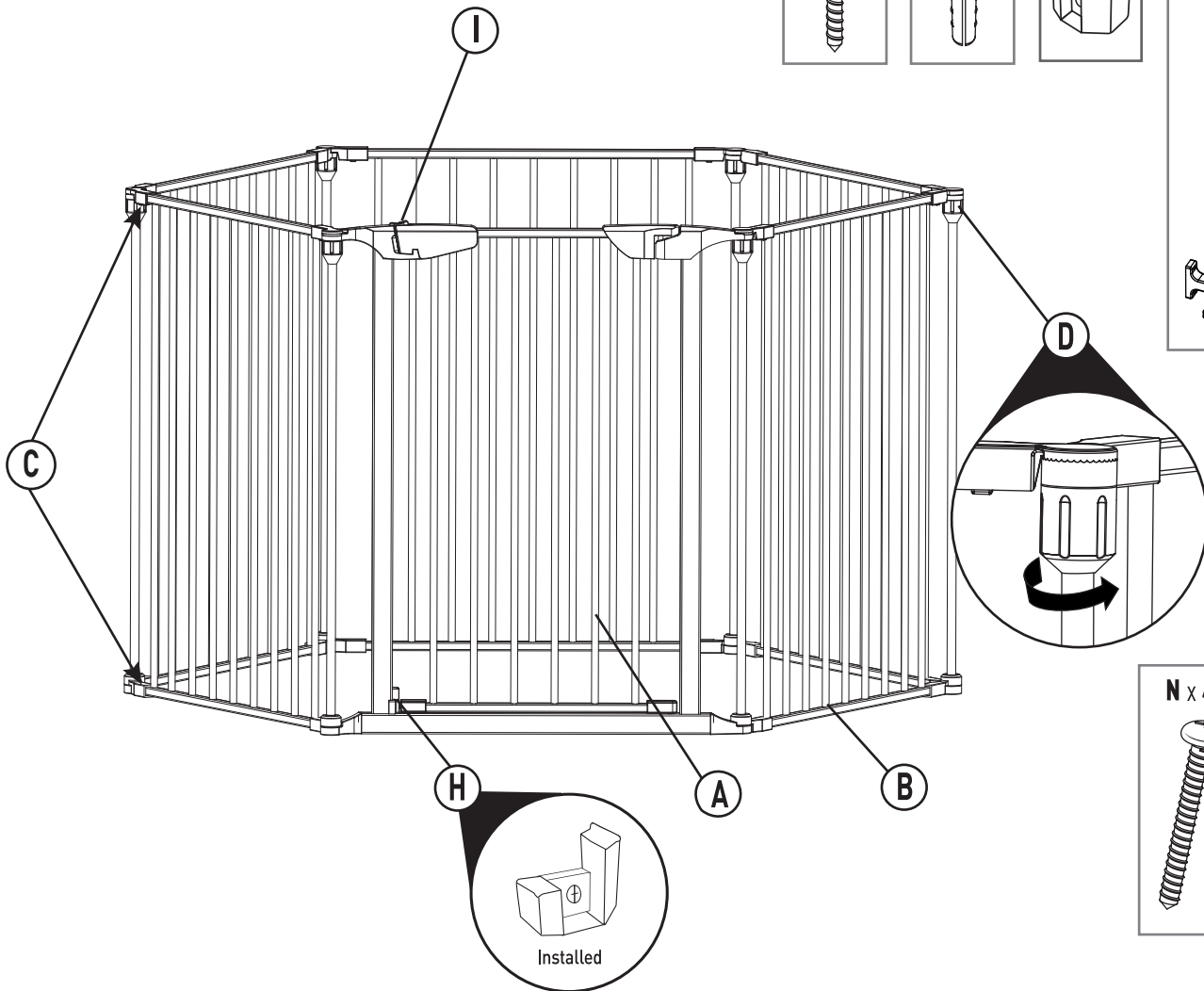

WARNING: This package contains small parts and sharp points in an unassembled state. Keep out of reach of children. Adult assembly required.

F2031 Brooklyn
Converta®
Play-Pen Gate

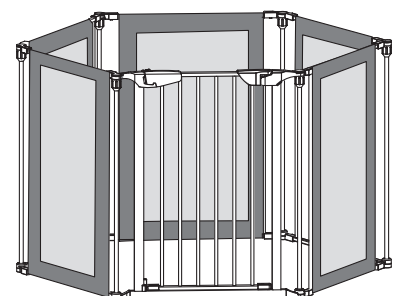

TO ASSEMBLE PLAY-PEN

1. Cut tie and unfold Barrier Panels (B) and Gate Panel (A).

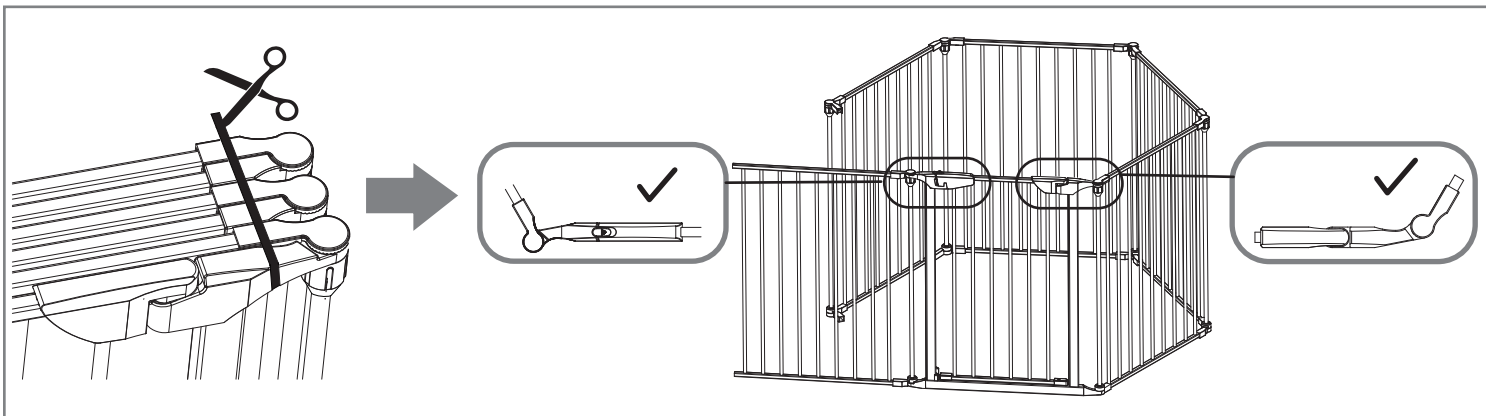

2. Push Release Button (C) and 'CLICK' into place.

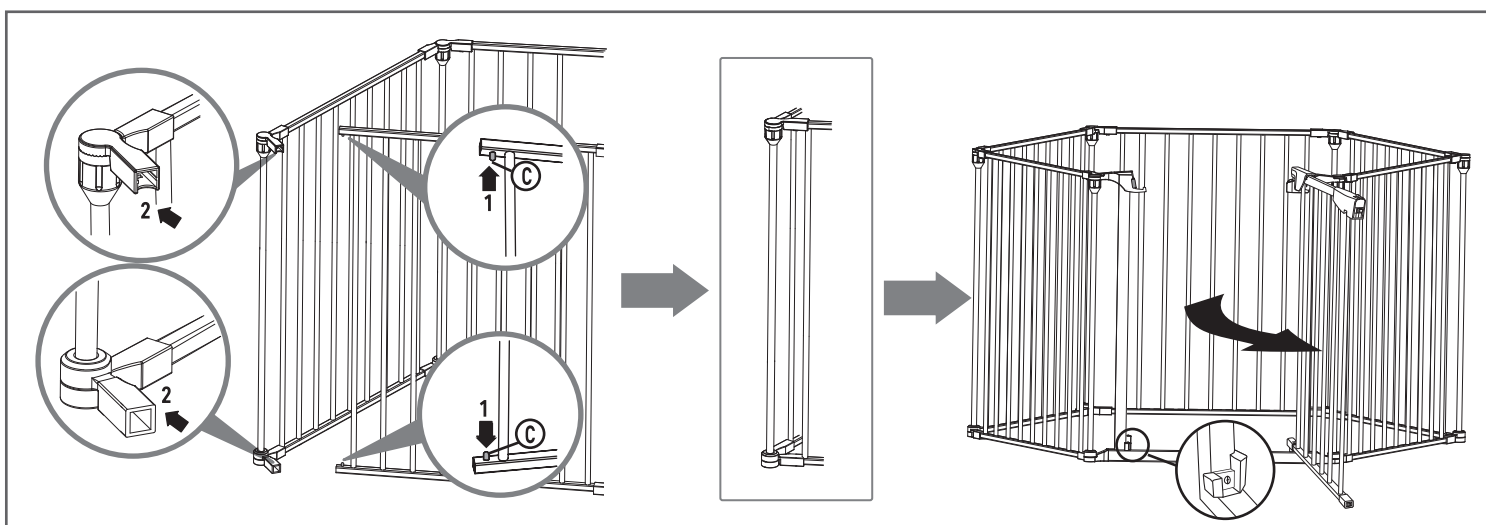

3. Tighten each Tension Knob (D) after positioning so the Play-Pen is secure. Check the tension before each use.

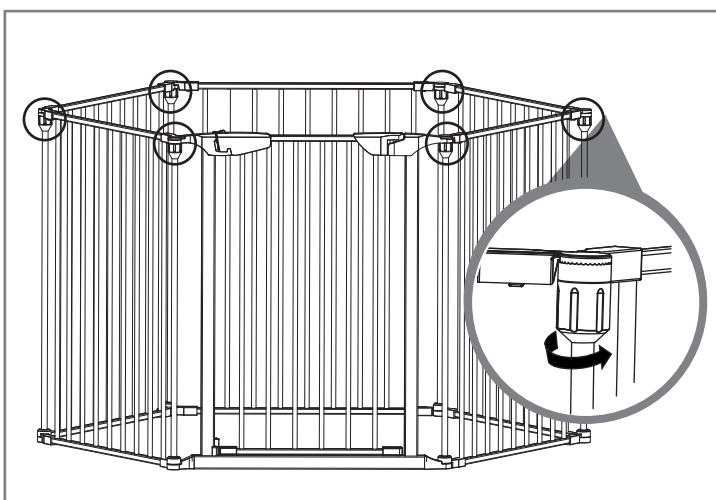

To Fit Dreambaby®
Converta® Play-Pen Mat
FL962/F2006/F2163
(sold separately).

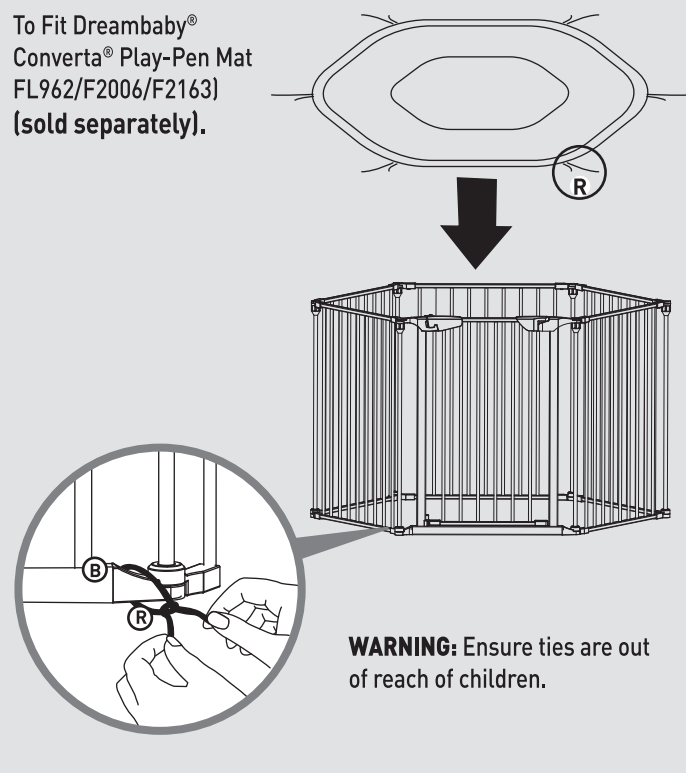

TO USE AS BARRIER GATE

1. Choose the best location for mounting Barrier Gate.

Ensure the surface you mount the Gate is structurally sound such as solid timber, brick or masonry.



For plaster/gyprock surface, locate the timber beam or stud behind and mount in this location (mounting on plaster/gyprock alone is not strong enough and not safe). DO NOT MOUNT TO GLASS.



Measure the gap where the gate will be installed.

85.5cm / 33.5in

375cm / 147.5in

DECIDE ON THE GATE OPENING DIRECTION

The gate is fitted with a One-Way Stopper (H) which restricts the swing to one direction.

It is important to choose which direction you want the gate to swing prior to installation.

Ensure that the position allows for the gate to fully open to enable the Stay-Open feature to work.

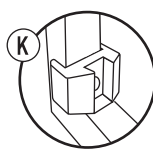
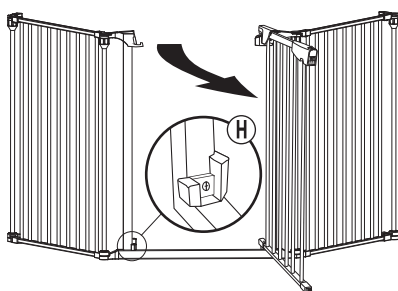

Alternatively, replace One-Way Stopper with 2-Way Switch (K).

GATE POSITIONING



Make sure that the gate can be mounted evenly in vertical positions.



TOP OF STAIRS

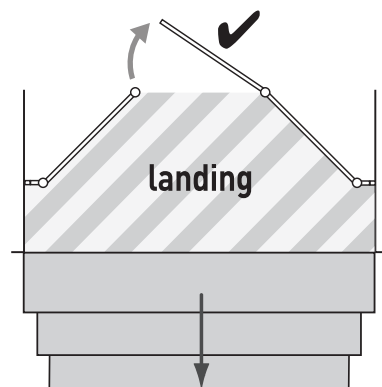
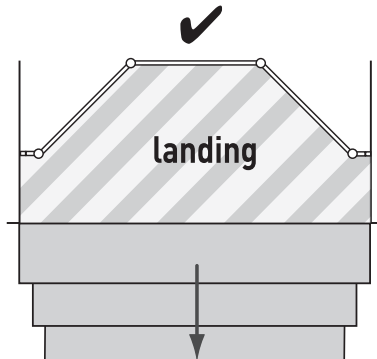
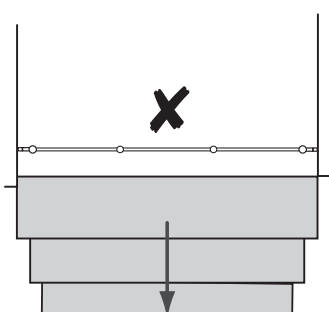
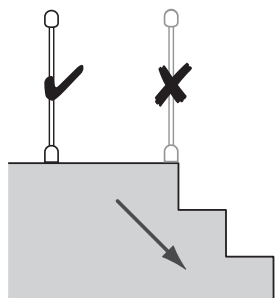

BOTTOM OF STAIRS

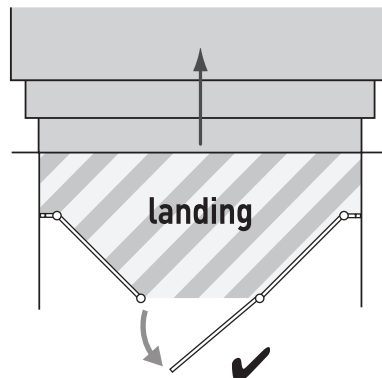
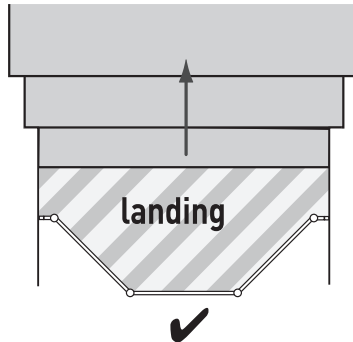
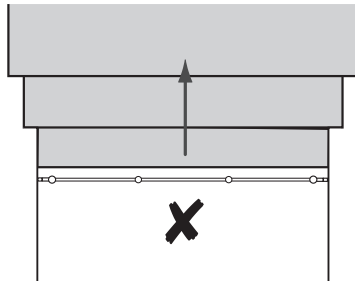
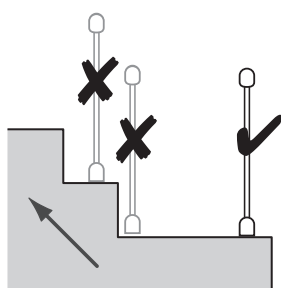

Gate can be used to create a landing area at the top or base of stairs. Never use at top of stairs directly across top step.



Ensure gate swings open away from stairs.

TO USE AS BARRIER GATE

2. Cut tie and unfold Barrier Panels (B) and Gate Panel (A).

The gate comes with the One-Way Stopper (H) fitted. Check gate opening direction before proceeding with installation. Alternatively, replace with 2-Way Switch (K).

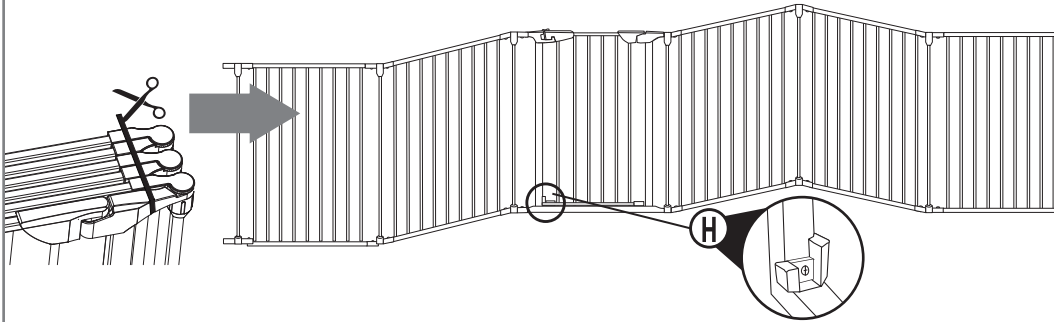

3. Assemble Connector (J) by installing Top (J1) and Base (J2).

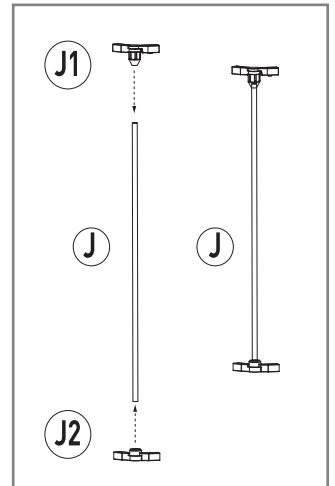

4. Install Connector (J) to the end Barrier Panel (B).

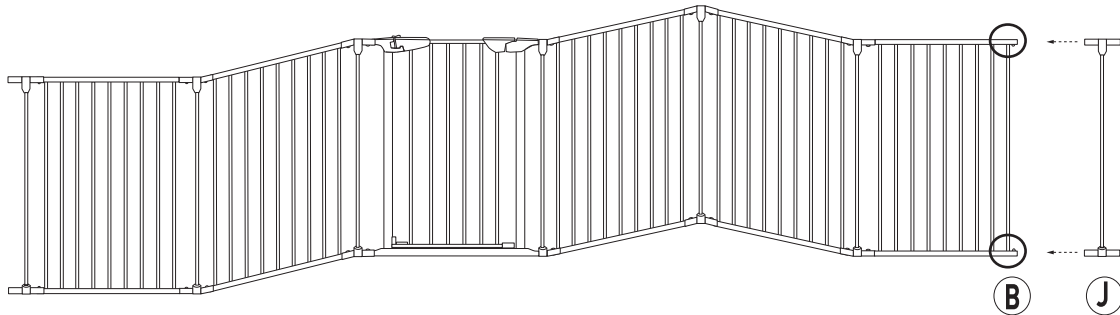

Push Release Button (C) and “CLICK” into place.

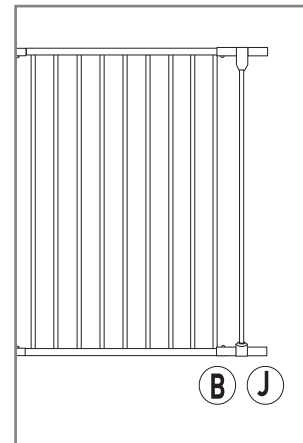
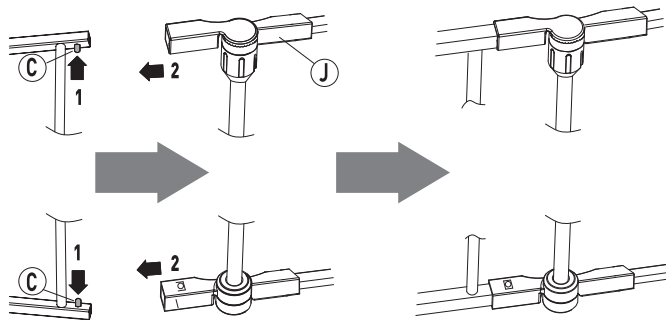

5. Install Wall Mounts (E) to the ends of Barrier Panel. Push Release Button (C) and “CLICK” into place.

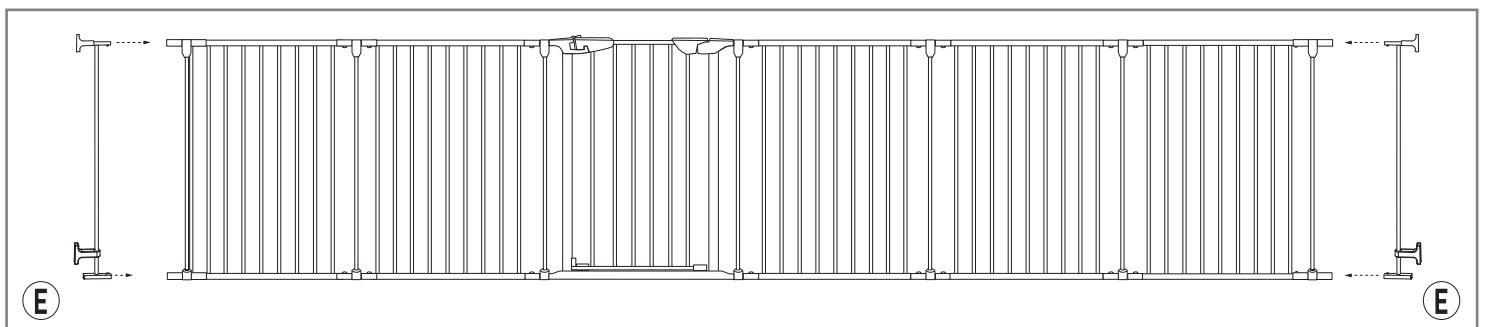

TO USE AS BARRIER GATE

- 6. Position in desired location with Wall Mounts (E) flat against the wall.**

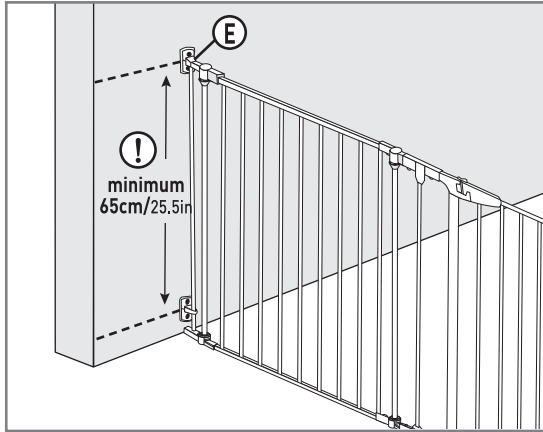

FOR WALLS WITH SKIRTING BOARDS



Use Spacers on top wall mount to match depth of the skirting boards.

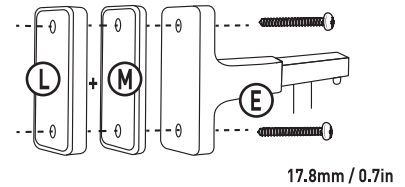
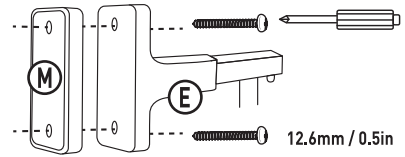
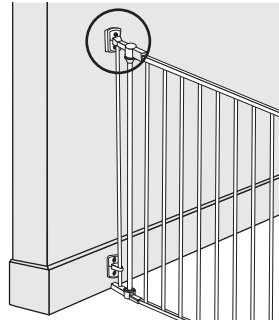

N x 4



- 7. Use pencil to mark screw holes positions.**

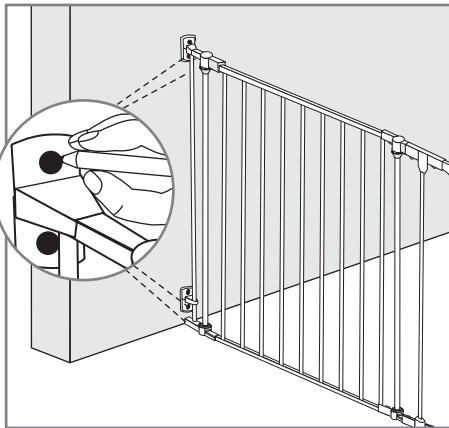

- 8. Remove Barrier Gate and drill pilot holes for screws.**

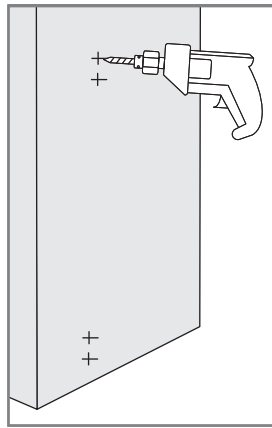

FOR TIMBER

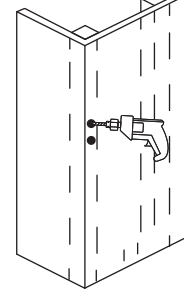

NOTE: For plaster/gyprock surface, locate the timber beam or stud behind and mount in this location (mounting on plaster/gyprock alone is not strong enough and not safe).

FOR BRICK/MASONRY

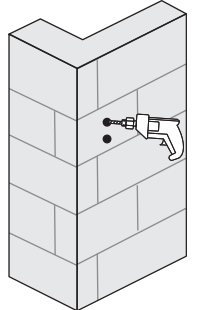

- 9. Reposition Barrier Gate and screw into place.**

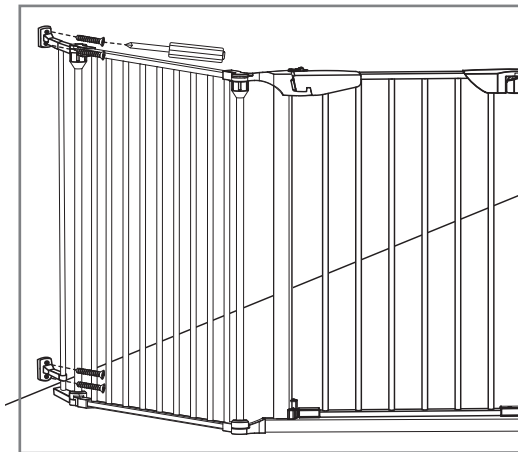

- 10. Tighten each Tension Knob (D) to secure the position.**

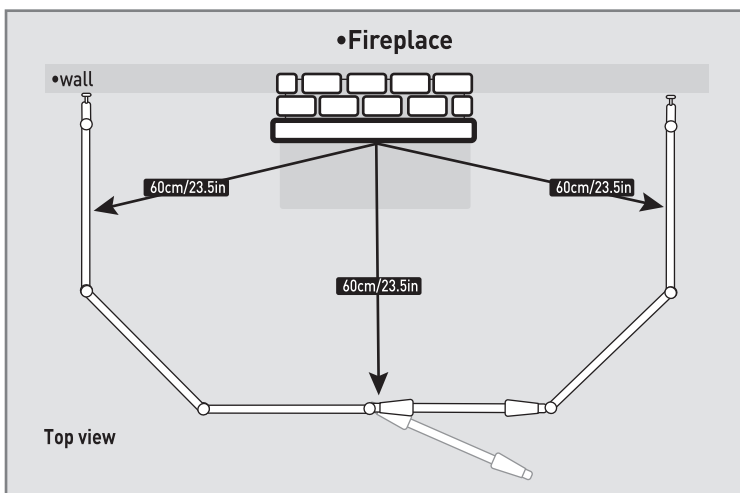
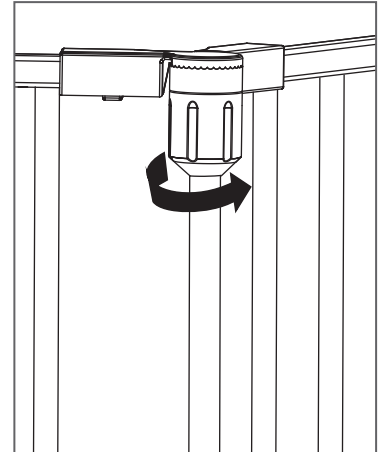

FIREPLACE BARRIER



Caution:

If using as a Fireplace Barrier, ensure Fireplace Barrier is installed at least 60cm / 23.5in from fire source.



WARNING: F2031 Brooklyn Converta® Gate is NOT SUITABLE for use as a Fireplace Barrier.

GATE OPERATION

Slide the Release Switch (I) and lift gate panel (A).
Swing gate closed ensuring locks are engaged.

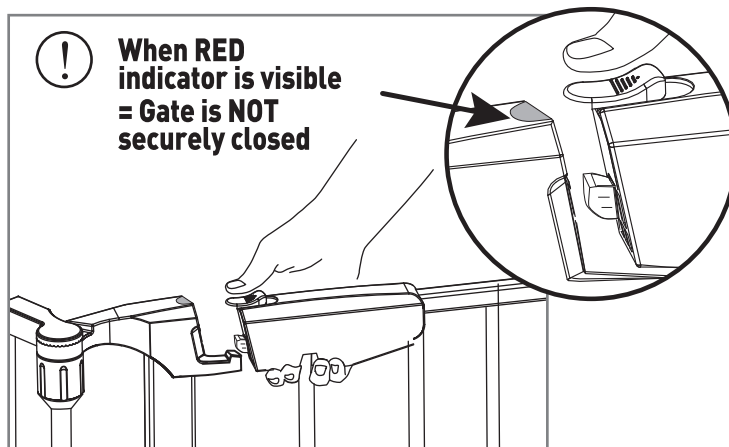
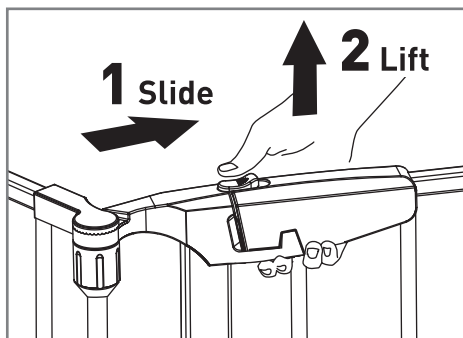

SMART STAY-OPEN SYSTEM

To engage the Smart Stay-Open System swing gate to its maximum opening.
Gate will stay open. Close as required.

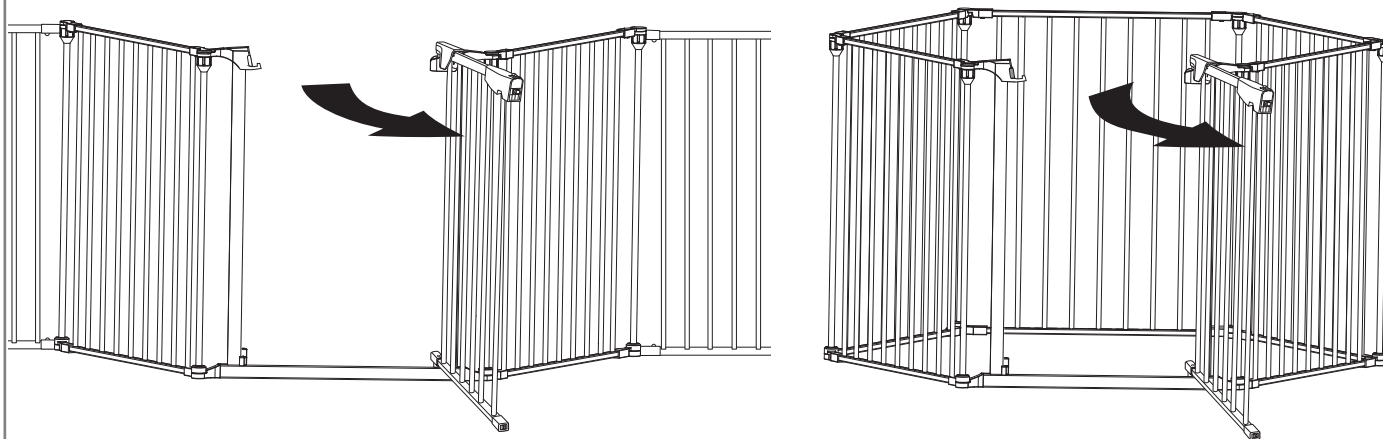

⚠ Caution: Keep gate closed when children are present.

ONE-WAY STOPPER / 2 WAY SWITCH

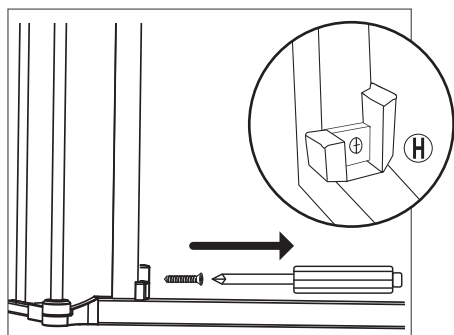

Using a Philips screwdriver, remove the screw holding the One-Way Stopper (H) in place.

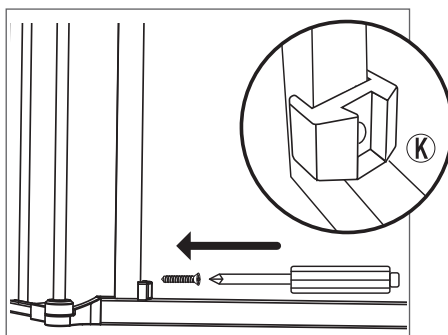

Remove One-Way Stopper (H) and replace with the 2 Way Switch (K).
Replace the holding screw.

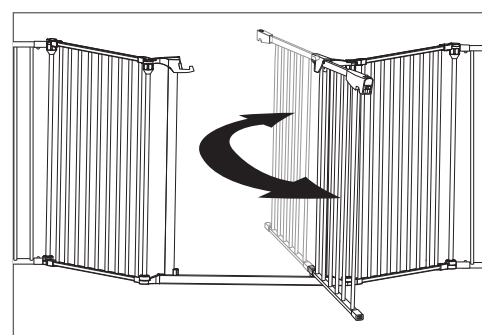

The gate will swing in both directions.

TO REMOVE OR ADD PANELS

TO REMOVE

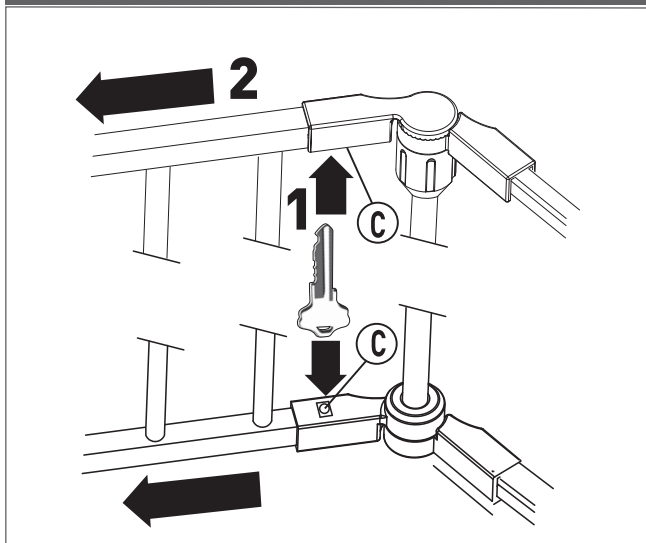

To remove Panels or Wall Mounts use a key to depress the Release Button (C).

ADD PANELS

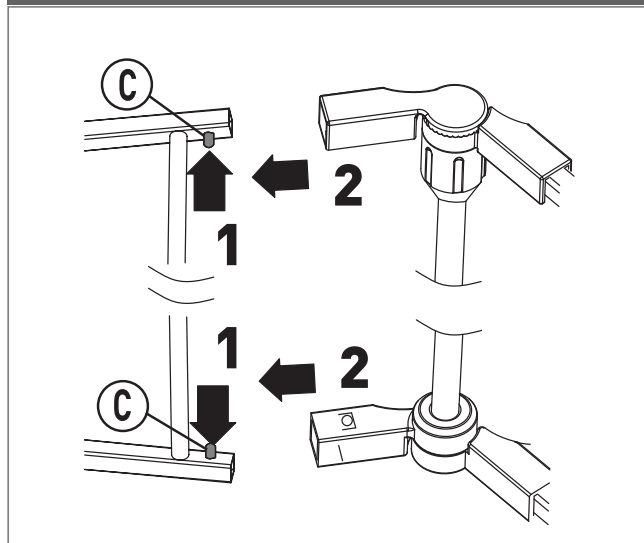

To add Panels. Push Release Button (C) and click into place.

Additional panels are available see www.dreambaby.com.au,
Dreambaby® (F2040/2041/2061).

MAINTENANCE & CARE

- Barrier Gate must be fitted according to instructions to ensure it works correctly.
- Regularly check Barrier Gate to ensure it is secure. Adjust as required.
- Regularly check that Wall Mounts and Tension Knobs are securely in place.
- Do not use the safety gate if any components are damaged or missing.
- To clean, wipe surface with a damp cloth using mild detergent and warm water.
Never clean with abrasive, ammonia, bleach based or spirit type cleaners.
- Any additional and replacement parts should be obtained from Tee-Zed Products.



Tee-Zed acknowledges that its customers may be entitled to statutory consumer guarantees and does not seek to exclude or limit them. These guarantees include that Tee-Zed's products are of acceptable quality. This Tee-Zed product is for the specific purpose detailed in the instructions and packaging and Tee-Zed considers use outside of that purpose to be abnormal use. To the maximum extent permitted by law, Tee-Zed does not accept any liability for damage:

- arising from abnormal use of the products;
- caused by installation or removal of the products other than in accordance with the supplied installation and removal instructions; or
- arising under the law of tort or contract.

Tee-Zed Products Pty Ltd
PO Box 2022, Bondi Junction NSW 1355
Australia
☎ +61 (0)2 9386 4000
✉ info@tee-zed.com.au
www.dreambaby.com.au

Tee-Zed Products (N.Z.) Ltd
PO Box 64013,
Botany Town Centre Auckland
New Zealand
☎ +64 (0)9 274 8788
✉ info@tee-zed.co.nz
www.dreambaby.co.nz

Tee-Zed Products Ltd
PO Box 29227,
Dunfermline, KY12 2DN
United Kingdom
☎ +44 (0)844 800 9445
✉ info@tee-zed.co.uk
www.dreambaby.co.uk



Dreambaby® products by **Tee-Zed**
Made in Zhejiang, China.
©2017 Tee-Zed Products Pty Ltd

